

TID 2011 Award
Taiwan Interior Design

商業空間 Commercial space

記憶封存
Time freeze

鴻樣空間有限公司 Home Young Interior Design Ltd

主持設計師
Chief Designer

鄭惠心 Candy Cheng

協同設計師
Co-designer

盧奕縵 Shally Lu

許玉梅 Jude Hsu

攝影者
Photographer

鄭惠心 Candy Cheng
盧奕縵 Shally Lu



TIME FREEZE

記憶封存



大量的利用光的各種特性和理性幾何構圖，加上線性燈光點綴，折射、穿透、聚焦讓豐富空間的層次和穿越時的視覺變化在不同角度中呈現多種表情

In works, use a large number of light and geometric compositions design. By light's ornament, refraction, penetrating and focused let space layer and visual be changed in different point of spaces.



- 座落在歷史與文化交織起來的臺南店-九分十刻
- 以“記憶方盒”連結人和時空交錯的關係·打造出光影的空間重疊感
- It located in Tainan city where build by history and culture.
- Use square shape to symbolize memory box to connect people and time space' s relations for create the light of space' s overlapping sense.

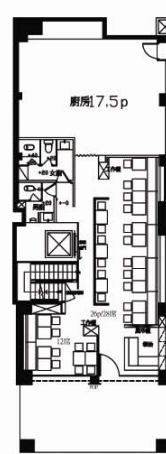
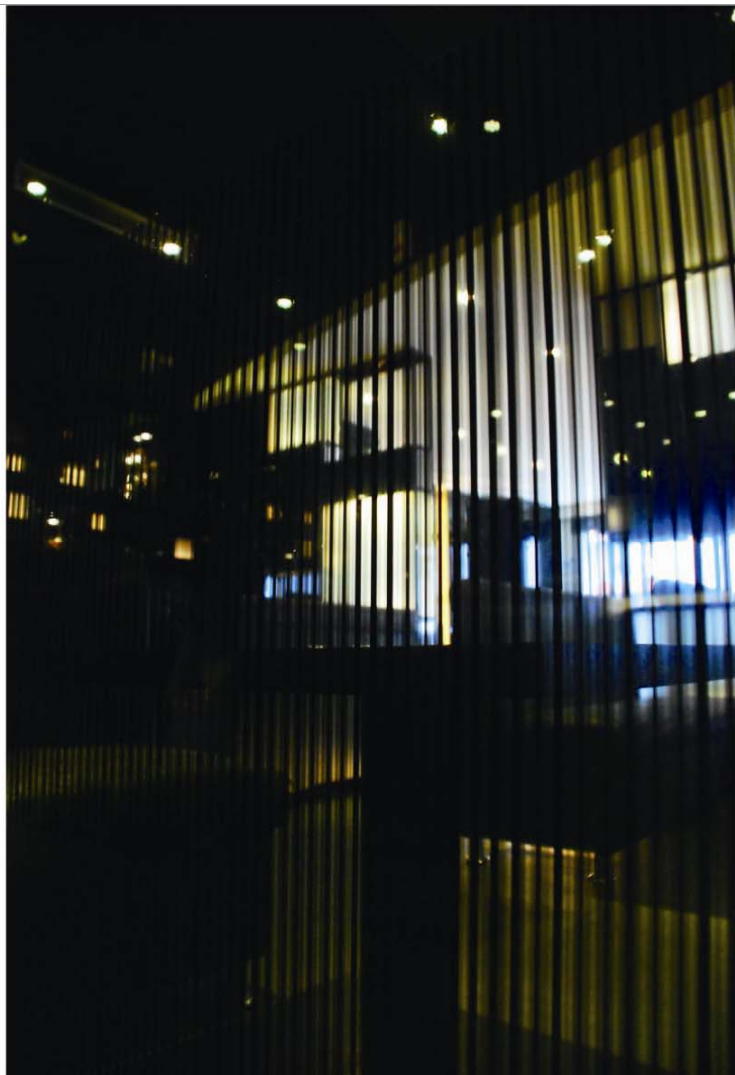

▲ First floor plan

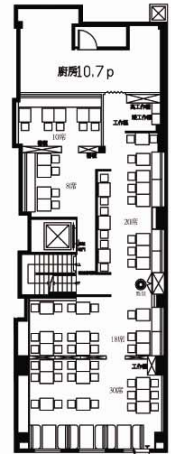

▲ Second floor plan

- 歷史的時光就像是記憶盒封存在我們的記憶裡
- 九分十刻是開啟時光的投影機
- History time is like memory boxes store in our memories.
- Nine min ten sec is a store which is a key of time machine.



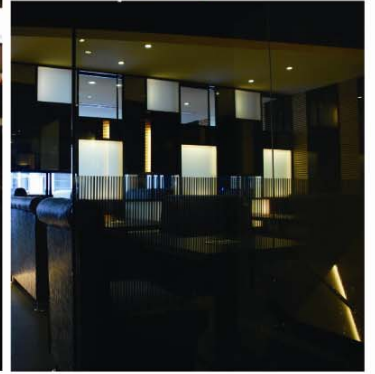

■ 於是進入餐廳彷彿感受到交錯的時空停留在眼前，當你再往前走一步，隨著你的身影移動，反射著光影變化

■ 利用靜的空間 創造動的時間

■ When entering the restaurant, you might feel the time holding in the space because the light changes the reflection as you' re moving.
We use quiet space to create vivid time.